

# Product datasheet

Specifications



## Base unit for modular tower lights, plastic, black, Ø70, bottom or side cable entry

XVBC07

⚠ To be discontinued on: 31-Dec-2025

⚠ To be discontinued

### Main

Range of product	Harmony XVB Universal
Product or component type	Base unit
Component name	XVBC
Material	Glass reinforced polyamide: base unit

### Complementary

Fixing mode	Direct or tube fixing
Mounting diameter	70 mm
Product destination	Banks without flash discharge tube unit
Electrical connection	1 connector for standard input
Cable entry	Bottom or side entry
Assembly style	Customer assembly, up to 5 units
Terminals description ISO n°1	(COM-2)PW (COM-3)PW (COM-1)PW (GND)GROUND (COM-4)PW (COM-5)PW
Net weight	0.16 kg

### Environment

Product certifications	CCC EAC CSA C22-2 No 14 UL 508
Standards	IEC 60947-5-1
Protective treatment	TC
Ambient air temperature for storage	-40...70 °C
NEMA degree of protection	Type 4X conforming to UL (indoor)

### Packing Units

Unit Type of Package 1	PCE
Number of Units in Package 1	1
Package 1 Height	10 cm
Package 1 Width	12 cm

<b>Package 1 Length</b>	10 cm
<b>Package 1 Weight</b>	170 g
<b>Unit Type of Package 2</b>	S03
<b>Number of Units in Package 2</b>	36
<b>Package 2 Height</b>	30 cm
<b>Package 2 Width</b>	30 cm
<b>Package 2 Length</b>	40 cm
<b>Package 2 Weight</b>	7 kg
<b>Unit Type of Package 3</b>	P06
<b>Number of Units in Package 3</b>	144
<b>Package 3 Height</b>	45 cm
<b>Package 3 Width</b>	60 cm
<b>Package 3 Length</b>	80 cm
<b>Package 3 Weight</b>	36.5 kg

## Contractual warranty

<b>Warranty</b>	18 months
-----------------	-----------

## Environmental Data

Schneider Electric aims to achieve Net Zero status by 2050 through supply chain partnerships, lower impact materials, and circularity via our ongoing “Use Better, Use Longer, Use Again” campaign to extend product lifetimes and recyclability.

[How this information helps you >](#)

### Environmental footprint

Carbon footprint (kg.eq.CO2 per CR, Total Life cycle)	2
---	---

Environmental Disclosure	<a href="#">Product Environmental Profile</a>
--------------------------	---

## Use Better

### Materials and Substances

Packaging made with recycled cardboard	No
--	----

Packaging without single use plastic	No
--------------------------------------	----

EU RoHS Directive	Pro-active compliance (Product out of EU RoHS legal scope)
-------------------	--

SCIP Number	124e2d7a-5b1e-45ca-b93c-220dd91b55b6
-------------	--------------------------------------

REACH Regulation	<a href="#">REACH Declaration</a>
------------------	-----------------------------------

China RoHS Regulation	<a href="#">China RoHS declaration</a>
-----------------------	--

## Use Again

### Repack and remanufacture

Circularity Profile	No need of specific recycling operations
---------------------	--

WEEE



The product must be disposed on European Union markets following specific waste collection and never end up in rubbish bins

---

Take-back

No

---

Dimensions Drawings

Indicator Bank with “Flash” Discharge Tube Unit

Dimensions

Below drawing shows the minimum configuration of the product. Select the number of stages according to the product characteristics in order to get **b** dimension.

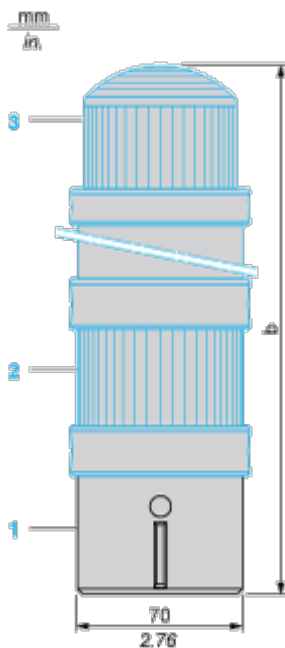

- (1) Base unit
- (2) Illuminated or audible signalling unit XVBC..., to be ordered separately
- (3) “Flash” unit XVBC..., to be ordered separately

Number of illuminated or audible signalling units other than “flash” tube	b in mm	b in in.
1	295	11.61
2	358	14.09
3	421	16.57
4	484	19.06

Mounting and Clearance

Base Unit for Indicator Banks

---

Panel Cut-out for Direct Fixing

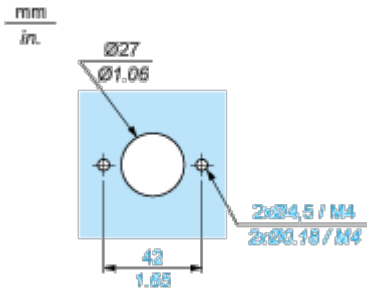

Connections and Schema

Illuminated Beacon

---

Wiring Diagram

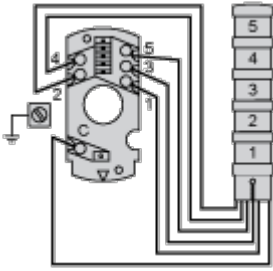

Technical Illustration

Dimensions

---

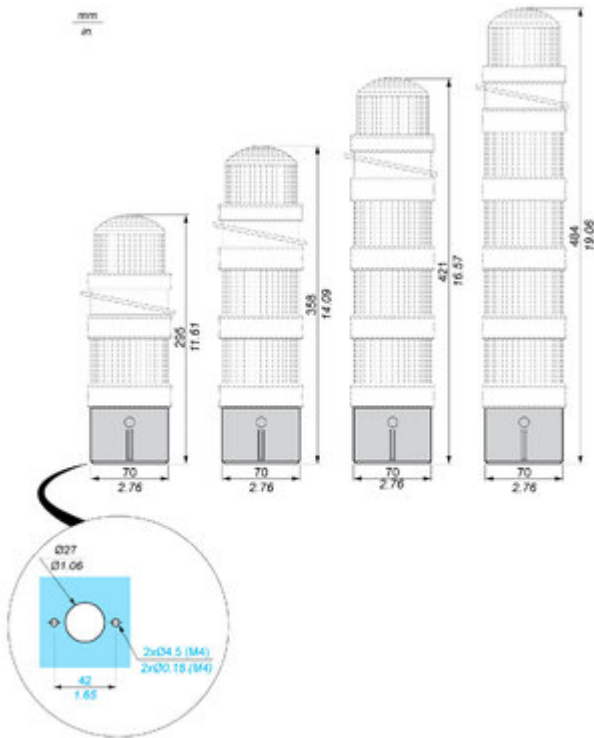



Technical Illustration

Wiring diagram

---

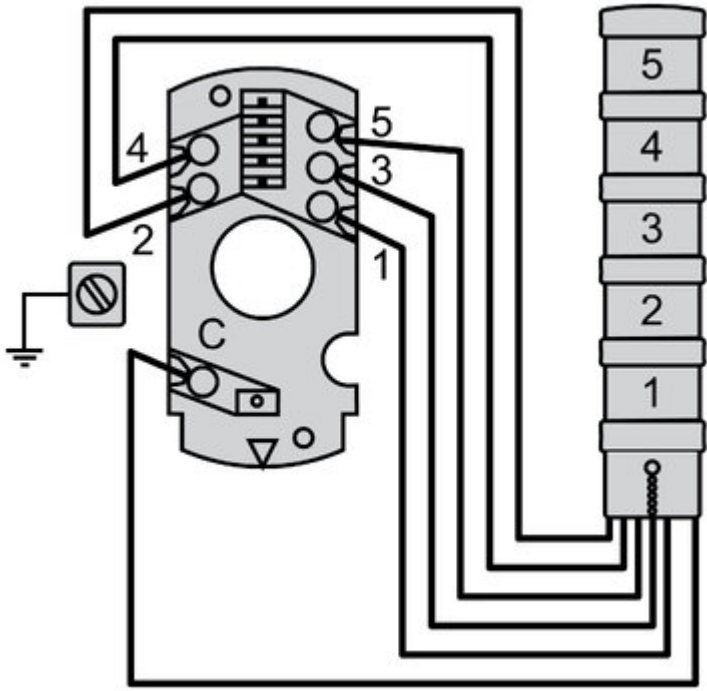

Offer Marketing Illustration

Product benefits / Features

---

## Technical Benefits

Harmony XVB

Robust product performance with high IP protection and IK05 shock resistance



Conformity with International standards



Greater loudness up to 90dB with continuous and intermittent tones



Beacon lens on top with high intensity 5J, 10J Xenon flash, increase visibility from top and surrounding



Image of product / Alternate images

Alternative

---







Image of product in real life situation

