

Product datasheet

Specifications



Ø 22 mm fixing hole - push button head with yellow lamp

ZB2BW35C

Main

| | |
|-------------------------------|----------------------------------|
| Range of product | Easy Harmony XB2 |
| Product or component type | Head for illuminated push-button |
| Bezel material | Chromium plated metal |
| Component name | ZB2 |
| Shape of signaling unit head | Round |
| Electrical circuit type | Control circuit |
| Type of operator | Spring return |
| Operator profile | Yellow flush, unmarked |
| Device presentation | Basic element |
| Head type | Flush |
| Device short name | XB2 |
| Sale per indivisible quantity | 1 |

Complementary

| | |
|-----------------------------|----------------|
| Mechanical durability | 3000000 cycles |
| Mounting diameter | 22.5 mm |
| Height | 29 mm |
| width | 29 mm |
| Depth | 34 mm |
| Net weight | 0.030 kg |
| Type of operator | spring return |
| Cap/operator or lens colour | Amber |
| Marking | Unmarked |
| Product certifications | CCC CE |
| customizable | No |
| Product compatibility | ZB2..C |

Environment

| | |
|---------------------------------------|--|
| Ambient air temperature for operation | -25...70 °C |
| Ambient air temperature for storage | -40...70 °C |
| Vibration resistance | 5 gn (f= 2...500 Hz) conforming to IEC 60068-2-6 |

| | |
|--------------------------------|--|
| Shock resistance | 30 gn (duration = 18 ms) for half sine wave acceleration conforming to IEC 60068-2-27 50 gn (duration = 11 ms) for half sine wave acceleration conforming to IEC 60068-2-27 |
| Overvoltage category | Class I conforming to IEC 60536 |
| IP degree of protection | IP65 |
| IK degree of protection | IK06 |
| Protective treatment | TC/TH |
| Standards | GB/T 14048.5 EN/IEC 60947-5-1 GB/T 14048.1 EN/IEC 60947-1 EN/IEC 60947-5-4 |

Packing Units

| | |
|-------------------------------------|-----------|
| Unit Type of Package 1 | PCE |
| Number of Units in Package 1 | 1 |
| Package 1 Height | 2.909 cm |
| Package 1 Width | 2.909 cm |
| Package 1 Length | 3.458 cm |
| Package 1 Weight | 28.4 g |
| Unit Type of Package 2 | S02 |
| Number of Units in Package 2 | 150 |
| Package 2 Height | 15 cm |
| Package 2 Width | 30 cm |
| Package 2 Length | 40 cm |
| Package 2 Weight | 5 kg |
| Unit Type of Package 3 | P06 |
| Number of Units in Package 3 | 3000 |
| Package 3 Height | 90 cm |
| Package 3 Width | 60 cm |
| Package 3 Length | 80 cm |
| Package 3 Weight | 91.191 kg |

Environmental Data

Schneider Electric aims to achieve Net Zero status by 2050 through supply chain partnerships, lower impact materials, and circularity via our ongoing “Use Better, Use Longer, Use Again” campaign to extend product lifetimes and recyclability.

[How this information helps you >](#)

Environmental footprint

| | |
|---|---|
| Carbon footprint (kg.eq.CO2 per CR, Total Life cycle) | 1 |
|---|---|

Environmental Disclosure

[Product Environmental Profile](#)

Use Better

Materials and Substances

| | |
|--------------------------------------|----|
| Packaging without single use plastic | No |
|--------------------------------------|----|

[EU RoHS Directive](#)

Pro-active compliance
(Product out of EU RoHS legal scope)

SCIP Number

9e63340a-2371-4381-8f9a-5fba0ff349a4

REACH Regulation

[REACH Declaration](#)

China RoHS Regulation

[China RoHS declaration](#)

Use Again

Repack and remanufacture

| | |
|---------------------|--|
| Circularity Profile | No need of specific recycling operations |
|---------------------|--|

| | |
|-----------|----|
| Take-back | No |
|-----------|----|

Dimensions Drawings

Dimensions

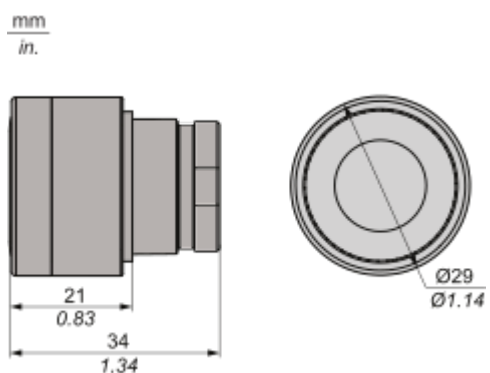

Mounting and Clearance

Mounting and Clearance

Panel cut-out

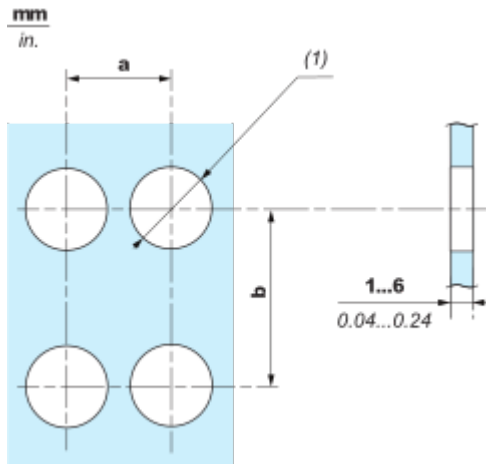

| | Connection by Screw clamp terminals | | | |
|--|-------------------------------------|----------|---------|----------|
| | a in mm | a in in. | b in mm | b in in. |
| •B2BA•C / •B2BL•C / •B2BP•C / •B2BS4•C / •B2BD•C / •B2BJ•C / •B2BG•C / •B2BW•C | 40 | 1.57 | 30 | 1.18 |
| •B2BC•C / •B2BS5•C / •B2BS8•C / •B2BT•C | 40 | 1.57 | 40 | 1.57 |
| •B2BR•C / •B2BS6•C | 60 | 2.36 | 60 | 2.36 |

(1) $\varnothing 22.5 \text{ mm} / 0.89 \text{ in. recommended } (\varnothing 22.3 \text{ mm }_0^{+0.4} / 0.88 \text{ in. }_0^{+0.016})$

Technical Illustration

Dimensions

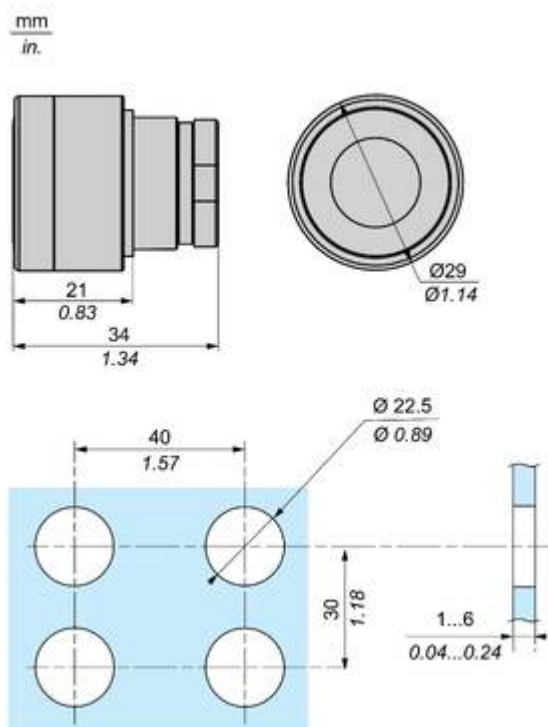

Offer Marketing Illustration

Product benefits / Features

Features
Easy Harmony XB2



- 

Metal bezels with metal fixing collars for impact endurance
- 

Designed to be used in numerous control and signaling applications
- 

Metal screws for secure fix, grounding contact to the panel and anti-rotation
- 

Simple modular design facilitates post installation servicing, modification and adaptation of machines by non-specialists
- 

Available in sub-assemblies for easy mix and match of functionalities

Image of product / Alternate images

Alternative

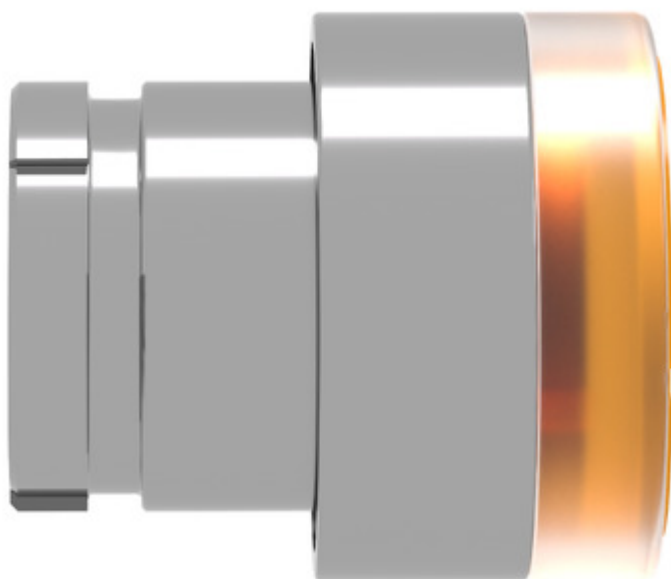
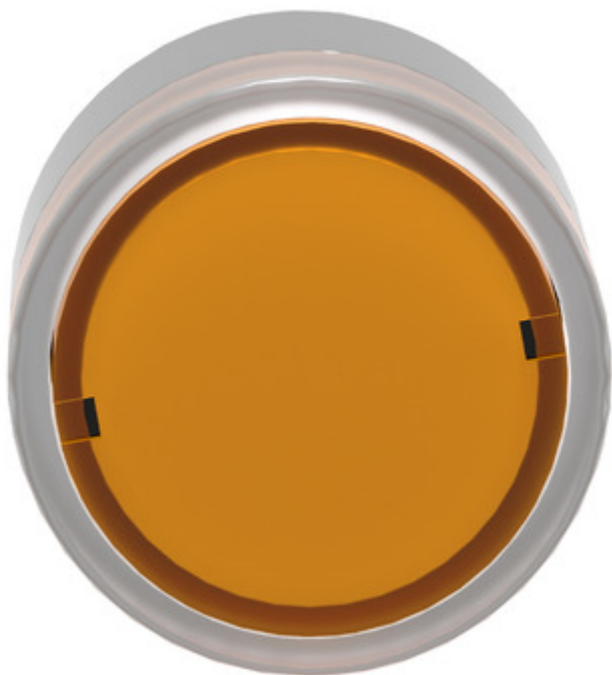

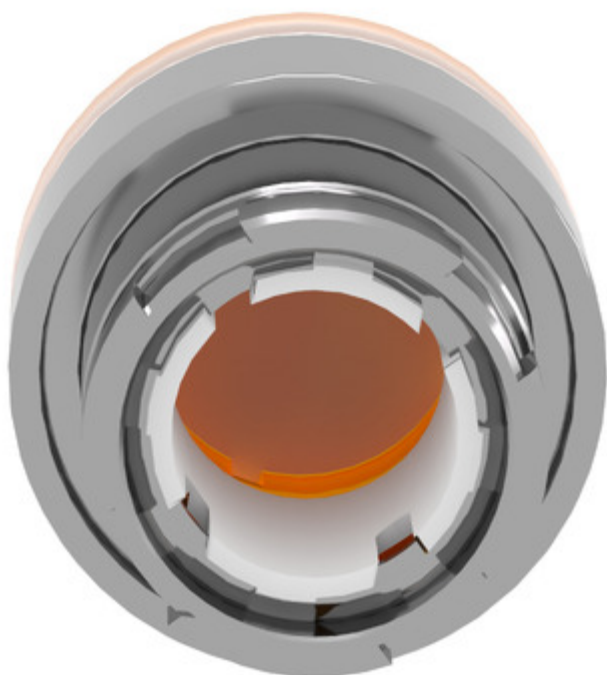
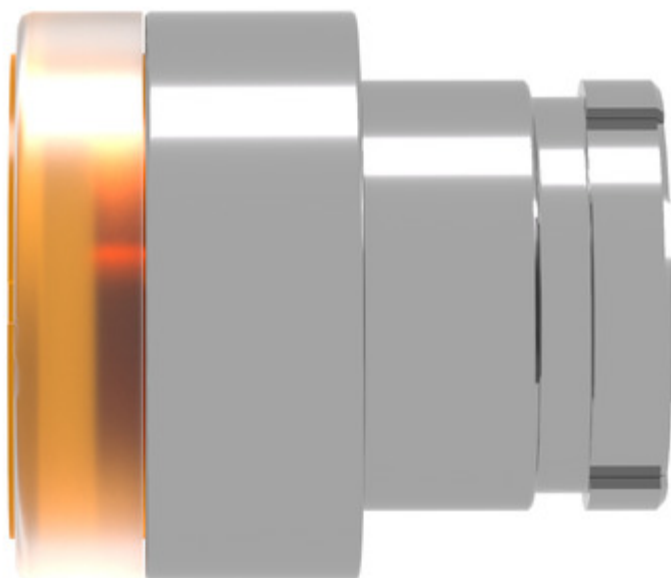



Image of product in real life situation

